

\$209,000 - 10525 83 Avenue, Edmonton

MLS® #E4442449

\$209,000

2 Bedroom, 1.00 Bathroom, 971 sqft
Condo / Townhouse on 0.00 Acres

Strathcona, Edmonton, AB

Welcome to this top floor 2-bedroom corner unit in the heart of Old Strathcona/University area that is just a few steps from Whyte Avenue. The open concept floor plan boasts over 970 square feet of living space with hardwood floors and porcelain tile throughout. There is an impressive gourmet kitchen which features custom cabinetry, black energy efficient appliances, granite countertops and a large central island. A spacious open living room and dining room lead out to the balcony. Down the hall you find 2 generous sized bedrooms, an updated four-piece bathroom and in-suite laundry complete this amazing unit. Additional amenities include assigned parking stall, and the building is pet friendly. This fantastic location puts you just steps away from schools, parks, and some of the best eateries in the city.



Built in 1968

Essential Information

MLS® #	E4442449
Price	\$209,000
Bedrooms	2
Bathrooms	1.00
Full Baths	1
Square Footage	971
Acres	0.00

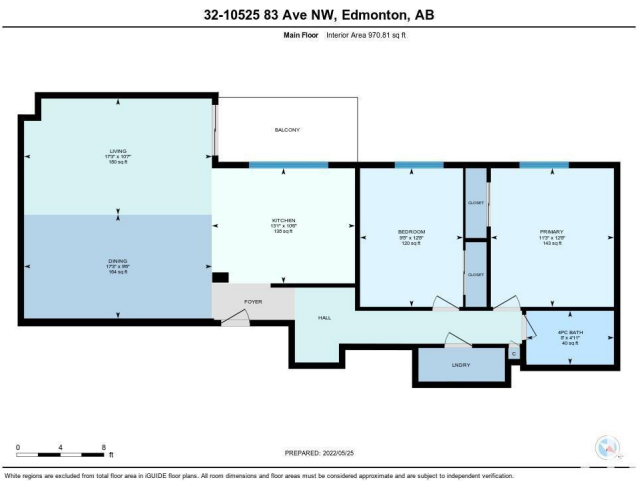

Year Built	1968
Type	Condo / Townhouse
Sub-Type	Lowrise Apartment
Style	Single Level Apartment
Status	Active

Community Information

Address	10525 83 Avenue
Area	Edmonton
Subdivision	Strathcona
City	Edmonton
County	ALBERTA
Province	AB
Postal Code	T6E 2E1

Amenities

Amenities	Security Door
Parking Spaces	1
Parking	Stall

Interior

Appliances	Dishwasher-Built-In, Dryer, Microwave Hood Fan, Refrigerator, Stove-Electric, Washer, Window Coverings
Heating	Baseboard, Water
# of Stories	3
Stories	1
Has Basement	Yes
Basement	None, No Basement

Exterior

Exterior	Wood, Brick, Stucco
Exterior Features	Back Lane, Golf Nearby, Playground Nearby, Public Transportation, Shopping Nearby, View City
Roof	Tar & Gravel
Construction	Wood, Brick, Stucco
Foundation	Concrete Perimeter

Additional Information

Date Listed	June 14th, 2025
-------------	-----------------

Days on Market	1
Zoning	Zone 15
Condo Fee	\$639

DATA IS DEEMED RELIABLE BUT IS NOT GUARANTEED ACCURATE BY THE REALTORS® ASSOCIATION OF EDMONTON. COPYRIGHT 2025 BY THE REALTORS® ASSOCIATION OF EDMONTON. ALL RIGHTS RESERVED. Trademarks are owned or controlled by the Canadian Real Estate Association (CREA) and identify real estate professionals who are members of CREA (REALTOR®, REALTORS®) and/or the quality of services they provide (MLS®, Multiple Listing Service®)

Listing information last updated on June 15th, 2025 at 10:17am MDT